

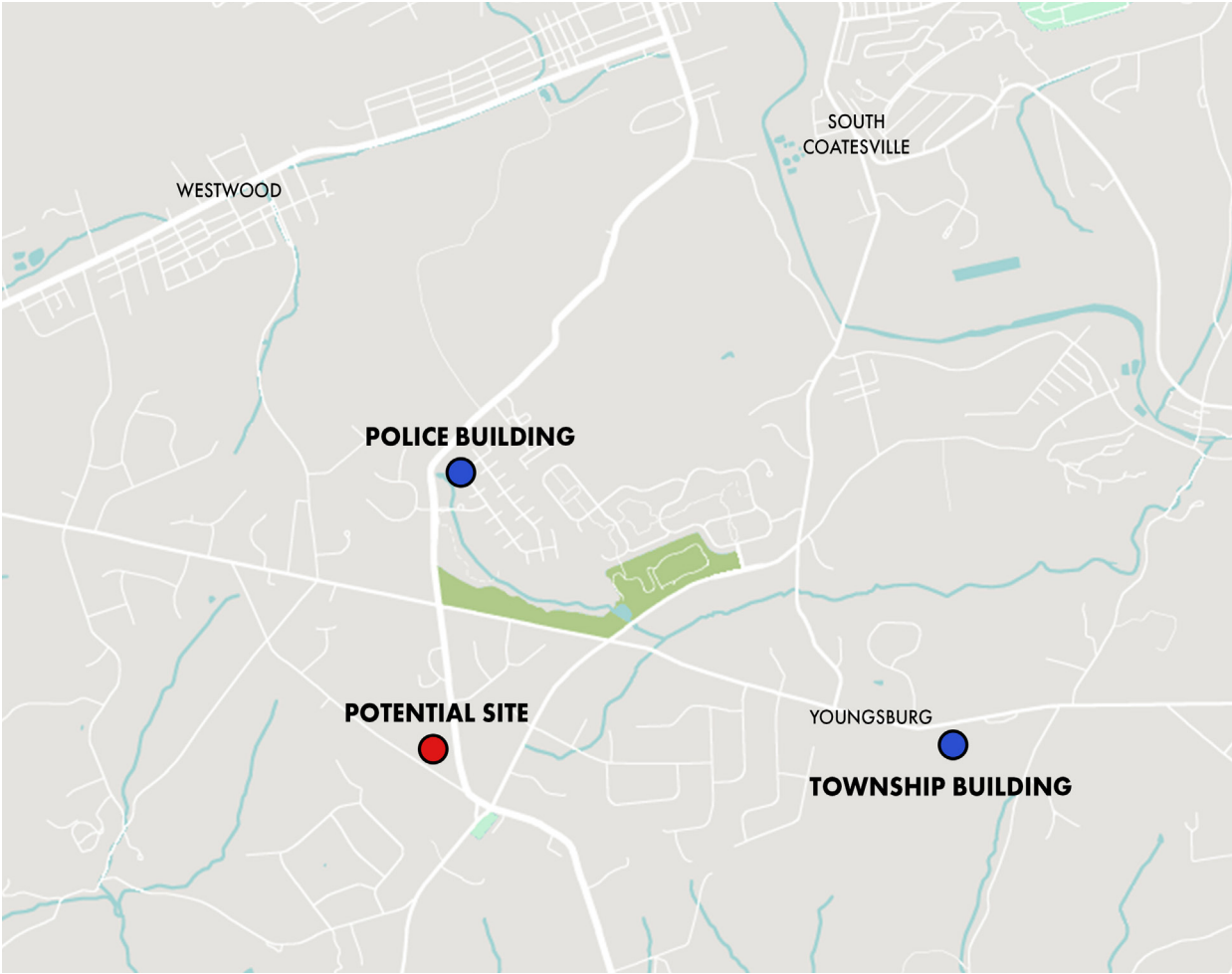

East Fallowfield Township Building

Concept Plan



PLAN PROGRESS

East Fallowfield Township Building

November 25, 2024

PROPOSED FLOOR PLAN

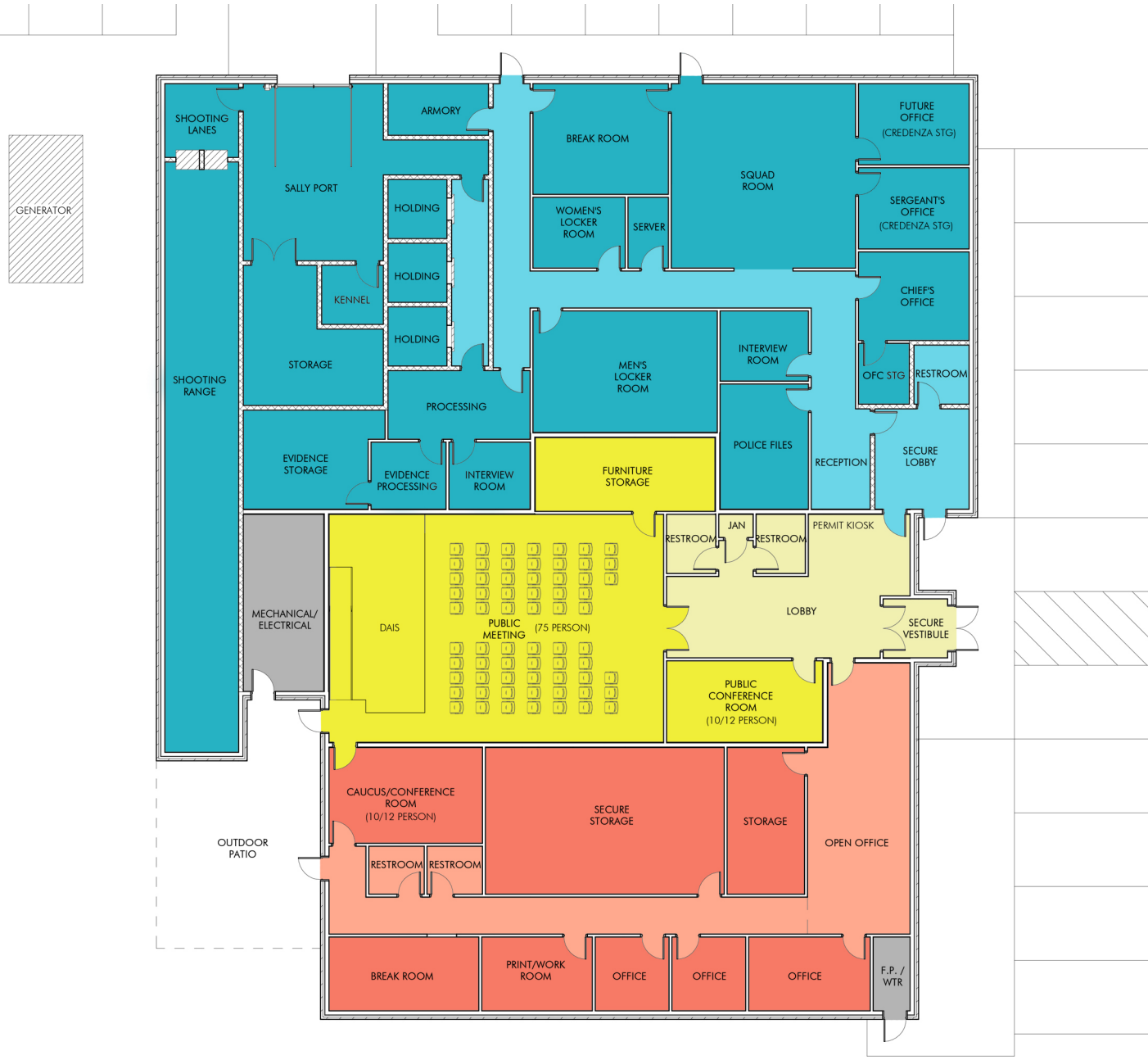

GROSS AREA

12,908 Square Feet

POLICE GSF

6,736 Square Feet

PUBLIC GSF

2,710 Square Feet

ADMIN GSF

3,091 Square Feet

$$3/64'' = 1' - 0''$$

PROPOSED SITE PLAN



LOT COVERAGE

APPROX. 9.7%

44,609 SF | 1.02 acres

50 Parking Spaces
21 Overflow spaces

1" = 130' - 0"

CHESTER COUNTY ARCHITECTURAL VERNACULAR

East Fallowfield Township Building

November 25, 2024

ARCHITECTURAL VERNACULAR

CHESTER COUNTY HISTORY

- *The vernacular architecture of Chester County is inspired by the practical and utilitarian needs of the area's early agrarian settlers, often Quakers, like our state's founder.*
- *Function over form dominated these simple structures, often devoid of much ornament*
- *Features often include:*
 - *Materials were often locally gathered fieldstone and white stuccoed stone walls*
 - *Gabled roof*
 - *Pent Eave*
 - *Symmetrical bays*
 - *Casement or double hung windows*
 - *Painted wood shutters, often paneled on the first floor and louvered above*
 - *Dormer windows, later as homes grew taller*
 - *Chimneys, sometimes a flush gable chimney*
 - *Later, the Federal, Greek Revival, and Italianate styles became more prominent influences*



Birmingham Friends Meetinghouse, 1763



Fallowfields Meetinghouse, 1811

ARCHITECTURAL VERNACULAR



Robert Wilson House, 1823



Bradford Friends Meetinghouse, 1764



Mansel Passmore House, 1830



White Horse Tavern, 1816